

# PRESSURE REDUCING VALVES

# 197

ARS

Inlet P max. 15 bar

Outlet P 0,5/4,0 bar

Max. temp. 80° Celsius

Screwed BSP



# 197

Stainless steel seat

Silicon steel spring

Piston operation

NBR O-rings

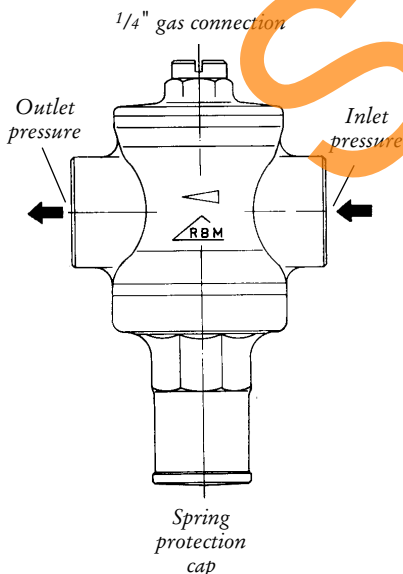

**Applications** - the maintenance of constant outlet flow conditions in systems handling water, air and other non-corrosive clean media compatible with the materials of construction. Ideal for domestic and building services installations or any application where constant outlet pressures lower than mains inlet pressures are desired. Limitations are 15 bar inlet pressure and 80° Celsius maximum temperature. Any media with suspended solids content must be filtered immediately upstream of the valve; failure to do so will result in malfunction. These valves offer long life, high repeatability and are exceptionally compact.

**Installation** - the pressure reducing valve should be installed with an upstream non-return valve, optional by-pass, isolating valves and, whenever possible, a line filter. Adjustments and final setting of the valve should be carried out with all fittings closed and a completely full circuit. A pressure gauge should be fitted.

**Operation** - pressure setting and adjustment is effected by removing the protection plug on the underside of the valve. The pressure adjusting screw located in the spring cap should be turned anti-clockwise to reduce outlet pressure, or clockwise to increase downstream pressure. The internal configuration comprises a precision engineered leakproof steel piston sliding against an O-ring. Positive single seating is achieved by a stainless steel ring. Flow occurs when the outlet pressure decreases and is out of balance with pressure exerted by the spring. When the user closes his outlet the piston remains open until pressure build up in the valve exerts sufficient force to offset the set pressure of the spring thus achieving pressure balance within the valve chamber. A 1/4" gas outlet is provided for installing a pressure gauge.

**Range** - INLET PRESSURE - up to 15 bar maximum  
 OUTLET PRESSURE - 0,5 bar up to 4 bar maximum.

## Materials

Part	Material	Part	Material
Body	Hot pressed brass and cast brass	O-ring	Nitrile (NBR)
Seat	Stainless steel AISI 304	Piston rod	Stainless steel AISI 304
Spring	Galvanised silicon steel	Finish	Nickel plated

**Testing** - each pressure reducer is tested for body and set tightness.

## Dimensions

DN	in	A	B	C	D	E
15	1/2	60	47	39	69	108
20	3/4	60	47	39	69	108
25	1	86	60	53	97	149

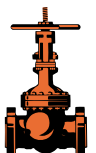
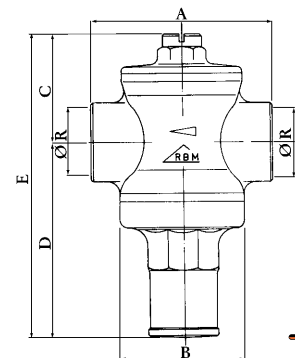

ITAP

**Options** - DN10, DN32, DN40 and DN50;  
 maximum 7 bar outlet pressure throughout the size range.